



RAMCO
TILE
FIX
HIGH PERFORMANCE TILE MORTAR

High
Performance
Tile Mortars &
Adhesive

RAMCO
EPOXY
TILE FIX

A tile adhesive is a bonding material used to fix tiles, mosaics or stones to surfaces like walls and floors. It provides strong adhesion, water resistance and flexibility for interior and exterior applications. Types include cement-based, epoxy adhesives, suitable for various materials and environments.

Ramco offers specialized types of tile mortar and adhesive to meet diverse construction requirements:

1. Ramco Tile Fix – Tile Mortar (cement based)

2. Ramco Tile Fix – Epoxy Tile Adhesive

Ramco Tile Fix is a specially formulated, cement-based tile mortar. Ramco Tile Fix is the easiest, fastest and most convenient way to fix your tiles. It protects your tiles and ensures a long life for your wall and floor surfaces.

Ramco Tile Fix (cement based) is available in five different variants to suit every tile application, both indoors and outdoors. It is the ideal choice for installing new tiles as well as for renovation works.



Ramco Epoxy Tile Fix is a premium, three-component adhesive designed for strong, durable bonds in vertical and horizontal applications. Suitable for tiles, stones and mosaics on surfaces like drywall, metal, wood and glass, it offers superior adhesion for interiors and exteriors. Ideal for industrial, commercial and residential spaces, it ensures water and chemical resistance and supports heavy-duty cladding for long-lasting installations.



Advantages

Ramco Tile Fix (cement based)

- Longer Life
- Excellent Bond Strength
- Good Workability
- Better Open Time
- Easy to use
- Anti-sagging
- No pre-soaking of Tiles

Ramco Epoxy Tile Fix

- Superior Bond Strength:** Provides stronger adhesion than standard tile adhesives.
- Water-Resistant:** Ideal for kitchens, bathrooms, and exteriors.
- Durable:** Resists chemicals, extreme temperatures, and heavy wear.
- Quick-Setting:** Speeds up installation with faster curing.
- No Shrinkage:** Maintains tile integrity with a stable bond.

Usage directions for Ramco Tile Fix - T2 to T6 variants



1 Clean the surface

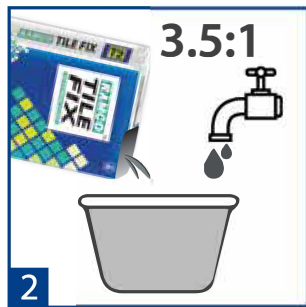

2 Mix Ramco Tile Fix with Water in a 3.5:1 ratio (powder : water)

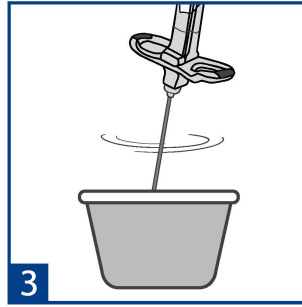

3 Stir well

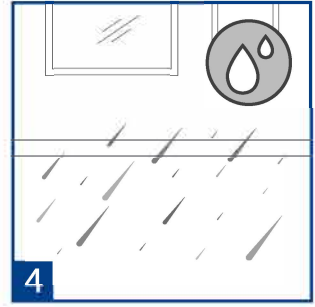

4 Wet the surface

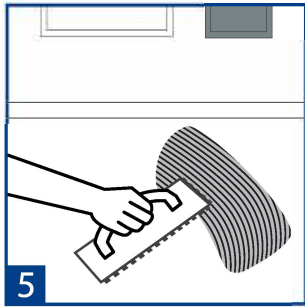

5 Apply mortar to the surface

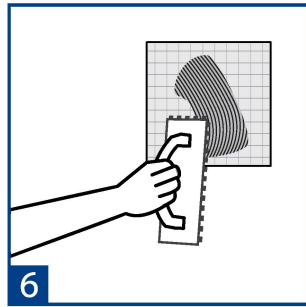

6 Back butter mortar to the tile

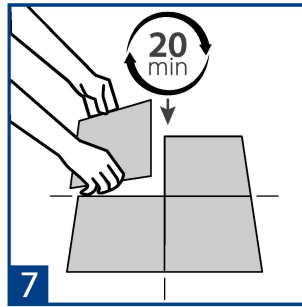

7 Fix the tile within 20 minutes of tile fix application



8 Use the mixed tile fix within 60 minutes (from the pot)

Ramco Tile Fix T2 - T6 variants available as 25kg and 40kg packs

Precaution : This product contains cement and contact with skin may cause irritation. It is advisable to wear a filter mask and protective clothing. In case of eye contact, wash copiously with water and if irritation persists, seek medical treatment.

Usage Instructions for Ramco Epoxy Tile Fix



Ensure the substrate is clean and dry.



Combine Part A with Part C, then mix with Part B to a smooth consistency using a slow-speed mixer.



Spread adhesive with a notch trowel. Maintain a 3-12mm thickness based on tile dimensions.



Position tiles within open time, press firmly with a slight twist and adjust using a rubber mallet.



After 24 hours, remove spacers, fill gaps with Ramco Epoxy Tile Grout and wipe excess grout with a damp sponge before it dries.

Pack Size

Available in 12 kg size containing

PART A – Resin – 3.5 Kg

PART B – Hardener – 3.5 Kg

PART C – Filler – 5.0 kg

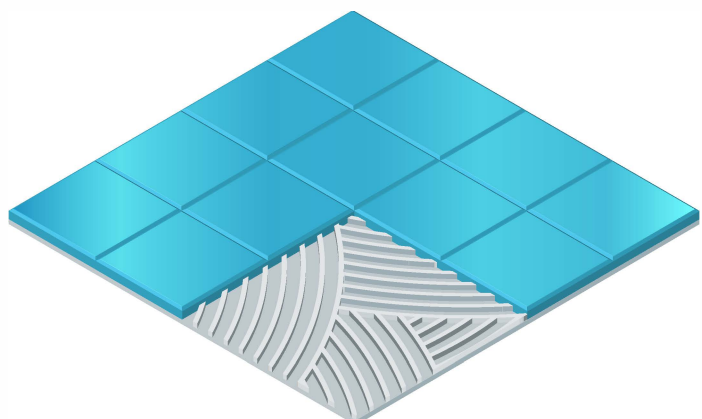

Application Matrix

BIS Classification	TYPE 1	TYPE 2	TYPE 3	TYPE 4		TYPE 5
Variants	T2	T3	T4	T5	T6	Epoxy Tile Fix
Type of Material	Cement-based					Epoxy-based
Application Thickness	3-6 mm	3-6 mm	6-12 mm	6-12 mm	6-12 mm	6-12 mm
Ceramic Tile floor	✓					
Ceramic Tile wall	✓	✓				
Vitrified Tile floor	✓	✓	✓			
Vitrified Tile wall		✓	✓	✓		
Granite floor	✓	✓	✓	✓		
Granite wall			✓	✓		
External Tile / Granite cladding			✓	✓		
External Tile / Granite cladding (Big Size)			✓	✓		✓
Natural stone cladding			✓	✓	✓	
Natural stone cladding (Big Size)			✓	✓	✓	✓
Marble floor	✓				✓	
Marble wall					✓	
Swimming pool - Ceramic tile			✓	✓	✓	
Swimming pool - Glass mosaic					✓	✓
Tile on Mosaic				✓		
Tile on Tile				✓		✓
Tile on Granite				✓		✓
Granite on Granite				✓		✓
On Drywall				T5 S1 & S2		✓
On Glass						✓
On Wood						✓
On Metal						✓
On Vinyl floorings						✓



Technical Specifications as per IS : 15477 - 2019 for Ramco Tile Fix & Ramco Epoxy Tile Fix

BIS Classification	TYPE 1		TYPE 2		TYPE 3		TYPE 4					TYPE 5		
Variants	T2				T4		T5		S1	S2	T6	Epoxy Tile Fix		
Type	Cement based											Epoxy based		
Tile Size	≤ 300 x 300 mm		>1200 x 1200 mm		>1200 x 1200 mm		1200 x 1200 to 1500 x 1500 (max 12mm thick tile)		1500 x 1500 to 2400 x 2400 (max 12mm thick tile)	1500 x 1500 to 2400 x 2400 (max 18mm thick tile)	1200 x 1200 to 1500 x 1500 (max 12mm thick tile)	Small to large size tiles		
Application Thickness	3-6 mm		3-6 mm		6-12 mm		6-12 mm		6-12 mm		6-12 mm	6-12 mm		
Appearance	Grey powder											White powder	Part A - Resin, Part B - Hardener, Part C - Filler	
Mixing Ratio	25 kg powder: 6-7 L of water											25 kg powder: 8-9 L of water	Part A - 3.5 kg + Part B - 3.5 kg + Part C - 5 kg	
	BIS limit	Result obtained	BIS limit	Result obtained	BIS limit	Result obtained	BIS limit	Result obtained	Result obtained	Result obtained	Result obtained	BIS limit	Result obtained	
Open Time	20 min	20 min	20 min	20 min	20 min	30 min	20 min	35 min	40 min	40 min	45 min	20 min	40 min	
Adjustability Time	30 min	30 min	30 min	30 min	30 min	40 min	30 min	45 min	50 min	50 min	50 min	30 min	50 min	
Tensile Strength (Dry) N/mm ²	0.5	0.6 - 0.8	1.0	1.2 - 1.4	1.5	1.5 -1.6	1.5	1.6 -1.7	1.6 -1.7	1.7 -1.8	1.8 -1.9	2	2 -3	
Tensile Strength (Wet) N/mm ²	-	-	1.0	1.2 - 1.4	1.0	1.3 -1.4	1.0	1.3 -1.4	1.3 -1.4	1.4 -1.5	1.6 -1.7	-	-	
Shear Strength (Dry) N/mm ²	1.0	1.0 - 1.2	1.25	1.3 -1.5	1.5	1.6 -1.7	1.5	1.7 -1.8	1.8 -1.9	1.8 -1.9	1.7 -1.8	6	6.5 - 7	
Shear Strength (Heat) N/mm ²	-	-	1.0	1.1 - 1.2	1.0	1.6 -1.7	1.0	1.4 -1.6	1.4 -1.6	1.4 -1.6	1.5 -1.6	3	5 - 6	
Shear Strength (Wet) N/mm ²	-	-		1.1 -1.2	1.0	1.6 -1.7	1.0	1.4 -1.6	1.4 -1.6	1.4 -1.6	1.5 -1.6	-	-	
Slip Resistance (mm)	max 0.5	Nil	max 0.5	Nil	max 0.5	Nil	max 0.5	Nil	Nil	Nil	Nil	max 0.5	Nil	
Deformability (mm)	-	-	-	-	-	-	min 2.5 for S1 min 5 for S2	-	3 - 4	5.5 - 6.5	-	-	-	
Water Resistance	Water Resistance											Waterproof		
Setting Time	6 - 8 hours		6 - 8 hours		6 - 8 hours		6 - 8 hours		6 - 8 hours	6 - 8 hours	6 - 8 hours	2 - 3 hours		
Coverage at 3mm thickness	3 - 4 sqft/kg		3 - 4 sqft/kg		3 - 4 sqft/kg		3 - 4 sqft/kg		3-4 sqft/kg	3-4 sqft/kg	3-4 sqft/kg	2 - 3 sqft / kg		
Chemical Resistance	Good		Good		Good		Good		Good	Good	Good	Excellent		
Surface Compatibility	Concrete, Cement plaster / Screed		Concrete, Cement plaster / Screed		Concrete, Cement plaster / Screed		Concrete, Cement plaster / Screed		Concrete, Cement plaster / Screed, Dry wall		Concrete, Cement plaster / Screed	Concrete, Drywall, Glass, Metal, Wood, Vinyl.		
Packaging	25 kg / 40 kg		25 kg / 40 kg		25 kg / 40 kg		25 kg / 40 kg		25kg/40kg	25kg/40kg	25 kg / 40 kg	12 kg		
Storage	Store in a dry place													
Shelf Life	6 months											12 months		

Storage instructions: Store in a covered, dry and moisture-free place.

Right Products **for** Right Applications

